

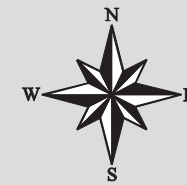

# GREENE TOWNSHIP MUNICIPAL PARK

Franklin County, Pennsylvania



## INFORMATION

Park is open daily from dawn until dusk.

Nearly 2 miles of walking trails can be found throughout our park.



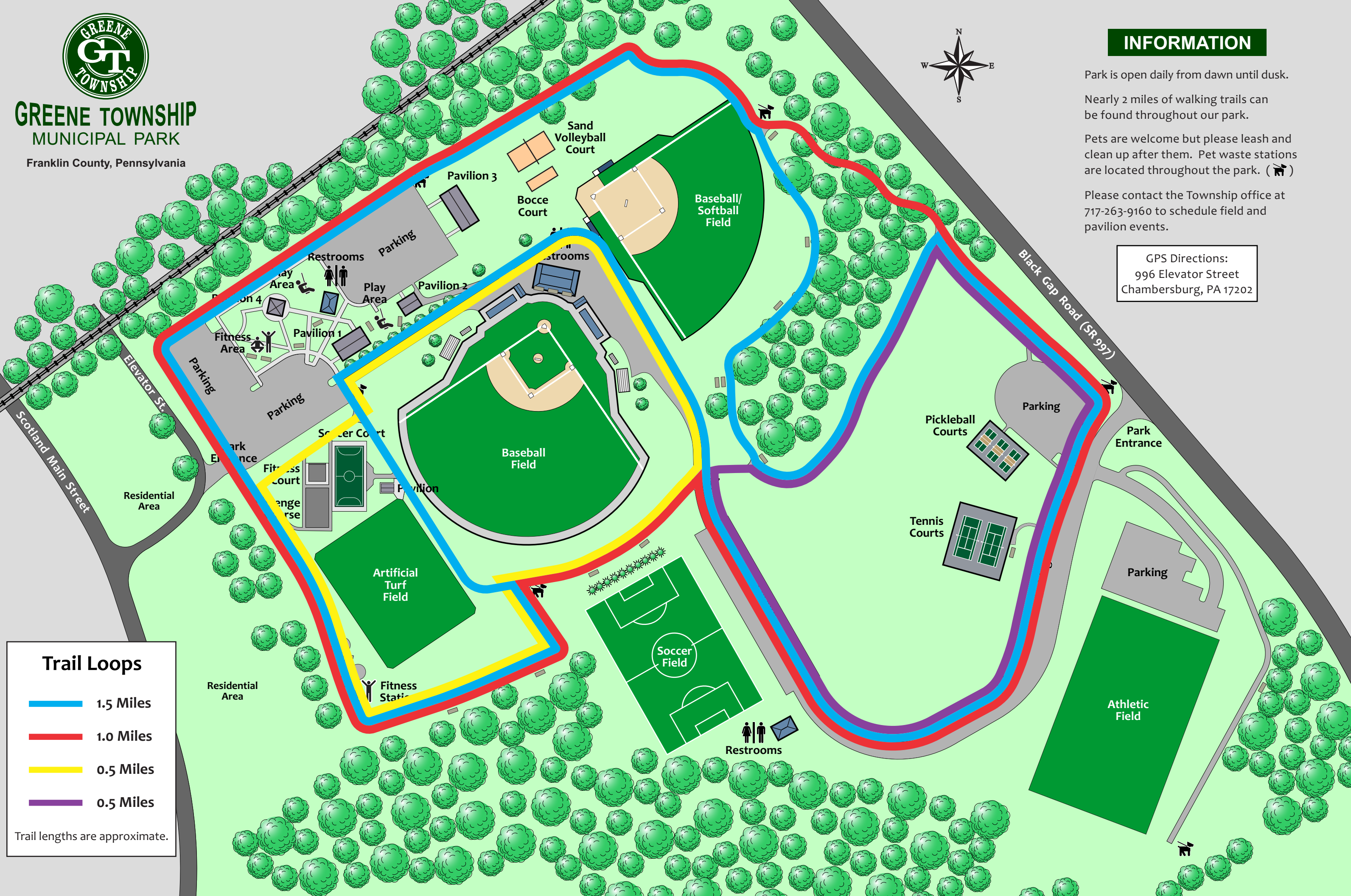

Pets are welcome but please leash and clean up after them. Pet waste stations are located throughout the park. (🗑️)

Please contact the Township office at 717-263-9160 to schedule field and pavilion events.

GPS Directions:  
996 Elevator Street  
Chambersburg, PA 17202



### Trail Loops

-  1.5 Miles
-  1.0 Miles
-  0.5 Miles
-  0.5 Miles

Trail lengths are approximate.